

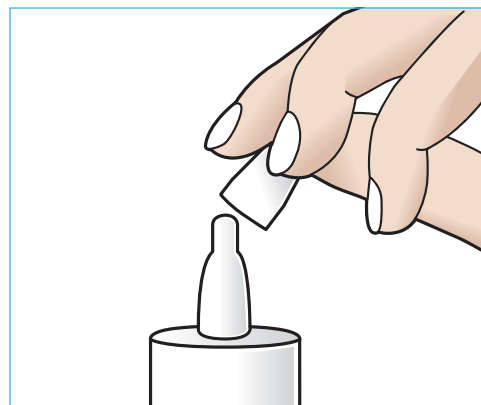

CONTINUOUS MONO DOSE

A PATIENT'S GUIDE



REMOVE THE CAP

You must remove the cap from the top of the bottle before use.

Do not discard the cap as you must replace it after use.



PRIMING THE SYSTEM

Before first use only, the bottle must be primed. To do this invert the bottle and pump the base 6-10 times until the first drop appears. The system is now ready for use.

COMPLIANCE AID
ComplEye

SCOPE



LONDON: Scope Ophthalmics, Leeds House,
4 Amberley Court, Whitworth Road,
County Oak Way, Crawley,
West Sussex, RH11 7XL
Freephone UK: **0800 270 0253**
www.scopeophthalmics.com

DUBLIN: Scope Ophthalmics, Suite 5, Westland House,
Westland Park, Willow Road, Dublin 12, Ireland
Freephone Ireland: **1800 816 005**
www.scopeophthalmics.ie
Email: info@scopeophthalmics.com

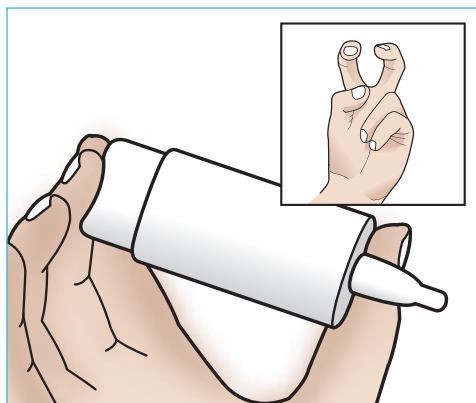

THE BUNNY GRIP

Place two fingers on the base of the bottle and your thumb on the shoulder, forming a 'bunny ears' like grip.



SUPPORTING HAND

For best use, use your free hand as a support to the hand holding the bottle and rest it against your face.



RELEASING ONE DROP

Pull down your lower eyelid using your support hand. Tilt your head back and press on the base to release one drop. Take care not to touch the tip of the bottle against your eye or lid margins.

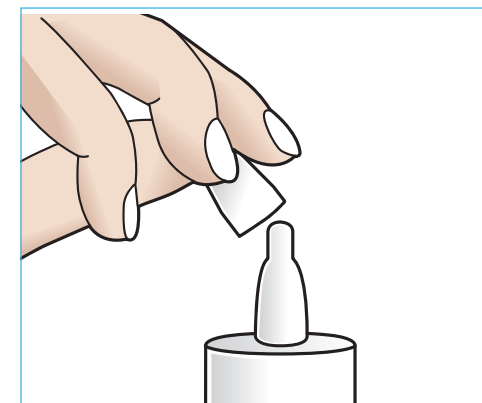

REPLACE THE CAP

Replace the cap on to the top of the bottle after use.

Try the
OPTASE® & HYLO®
eyecare regime to
help reduce symptoms of
**Meibomian Gland
Dysfunction, Blepharitis
and Dry Eye Disease**

HEAT

CLEANSE

HYDRATE

OPTASE®
MOIST HEAT MASK

Moist heat therapy
for the effective relief
from Meibomian
Gland Dysfunction,
Blepharitis and
Dry Eye Disease



- Simple to use, 25 seconds in the microwave
- Hydro beads deliver natural and controlled moist heat
- 10 minutes moist heat therapy
- Adjustable strap and protective pouch
- Soft and comfortable material
- Reusable and washable

HEAT

OPTASE®
TTO™ LID WIPES

Gentle and
preservative free,
Tea Tree Oil based
lid wipes to help
manage all types
of Blepharitis



- Unique formulation with tea tree oil
- Preservative free
- Soothing properties of Hyaluronic Acid, Chamomile & Aloe Vera
- Textured wipe assists in the removal of dandruff from the eyelids
- Individually wrapped (use one wipe per eye)

CLEANSE

HYLO®-FRESH

Recommended
for Mild Dry
Eye Disease



- Sterile for 6 months from time of opening
- Preservative free
- 0.03% Sodium Hyaluronate & Euphrasia
- Phosphate free
- 300 drops per 10 ml bottle
- Compatible with contact lenses

HYDRATE

HYLO®-TEAR

Recommended
for mild to moderate
Dry Eye Disease



- Sterile for 6 months from time of opening
- Preservative free
- 0.1% Sodium Hyaluronate
- Phosphate free
- 300 drops per 10 ml bottle
- Compatible with contact lenses

HYDRATE

HYLO®-FORTE

Recommended for
moderate to severe
and persistent cases
of Dry Eye Disease



- Sterile for 6 months from time of opening
- Preservative free
- 0.2% Sodium Hyaluronate
- Phosphate free
- 300 drops per 10 ml bottle
- Compatible with contact lenses
- 4 times higher viscosity than HYLO® - TEAR

HYDRATE

HYLO®-DUAL

Recommended for
lipid deficient and
allergy related Dry Eye
Disease – Stabilises the
lipid layer and protects
against allergens



- Sterile for 6 months from time of opening
- Preservative free
- 0.05% Sodium Hyaluronate & 2% Ectoin
- Phosphate free
- 300 drops per 10 ml bottle
- Compatible with contact lenses
- Excellent relief from itching & dry eye symptoms

HYDRATE

HYLO®-CARE

Recommended for
damage or injury to
the cornea, recurrent
erosion, post laser/
lasik, or in cases of
Dry Eye Disease



- Sterile for 6 months from time of opening
- Preservative free
- 0.1% Sodium Hyaluronate & 2% Dexpanthenol
- Phosphate free
- 300 drops per 10 ml bottle
- Compatible with contact lenses
- Excellent relief from dry eye symptoms

HYDRATE